

8

7

6

5

4

3

2

1

REV:	DESCRIPTION:	BY	DATE
A0	First Design	JSW	2018-03-20

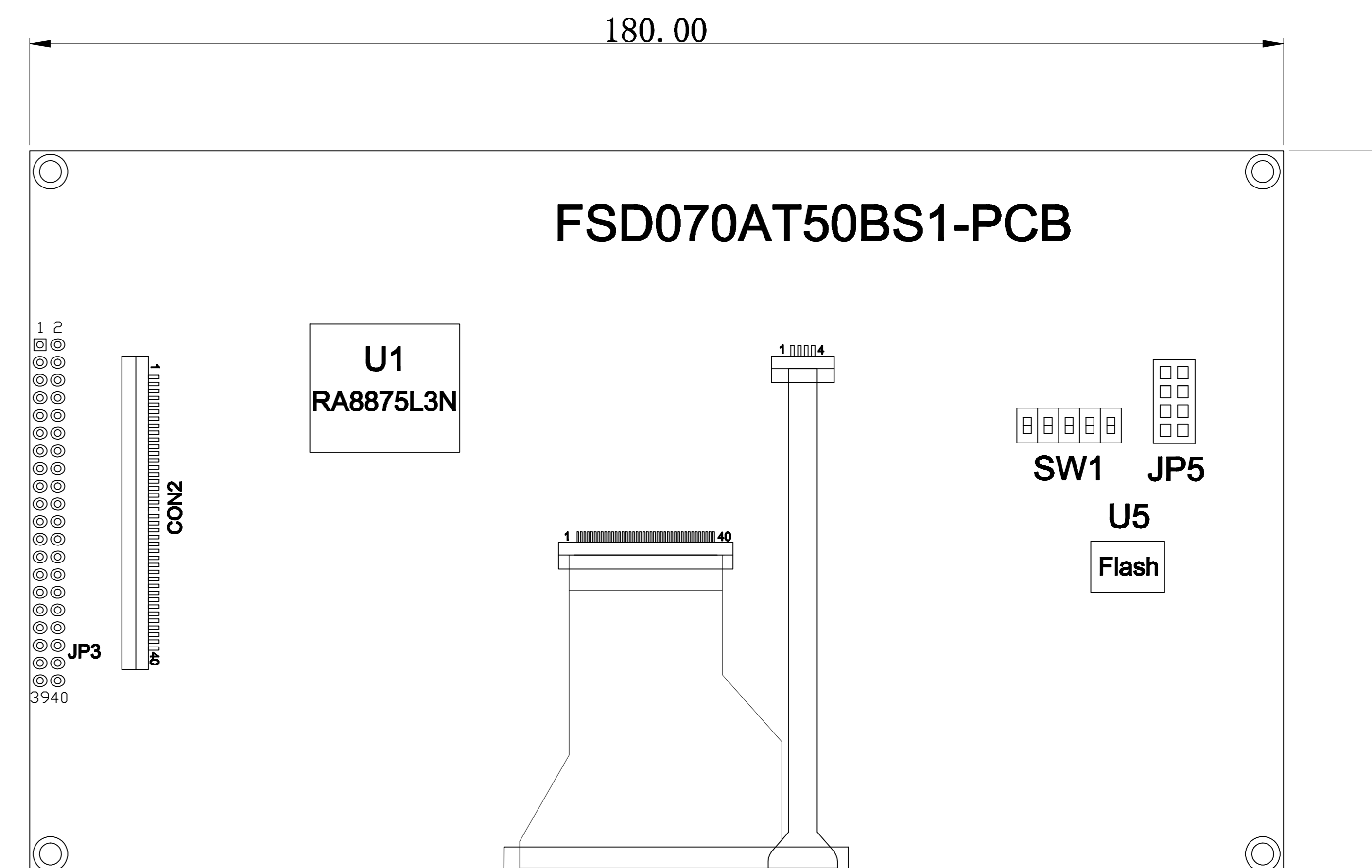
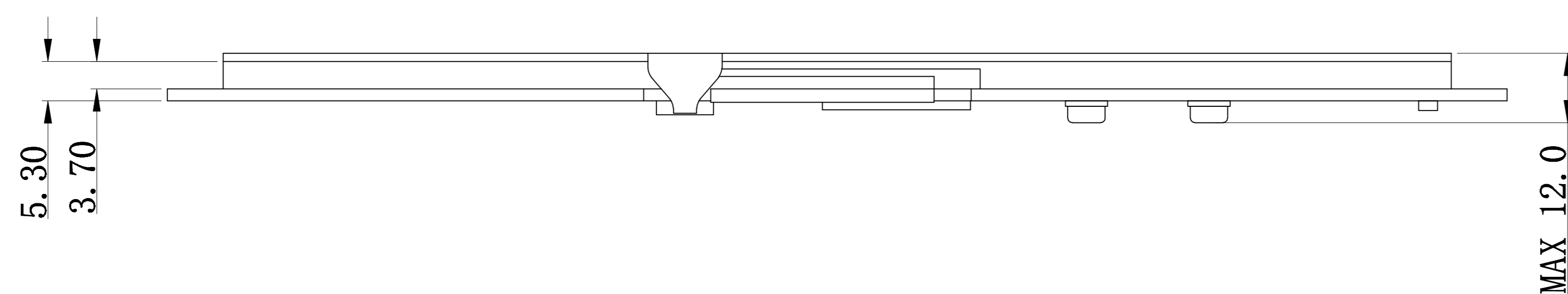
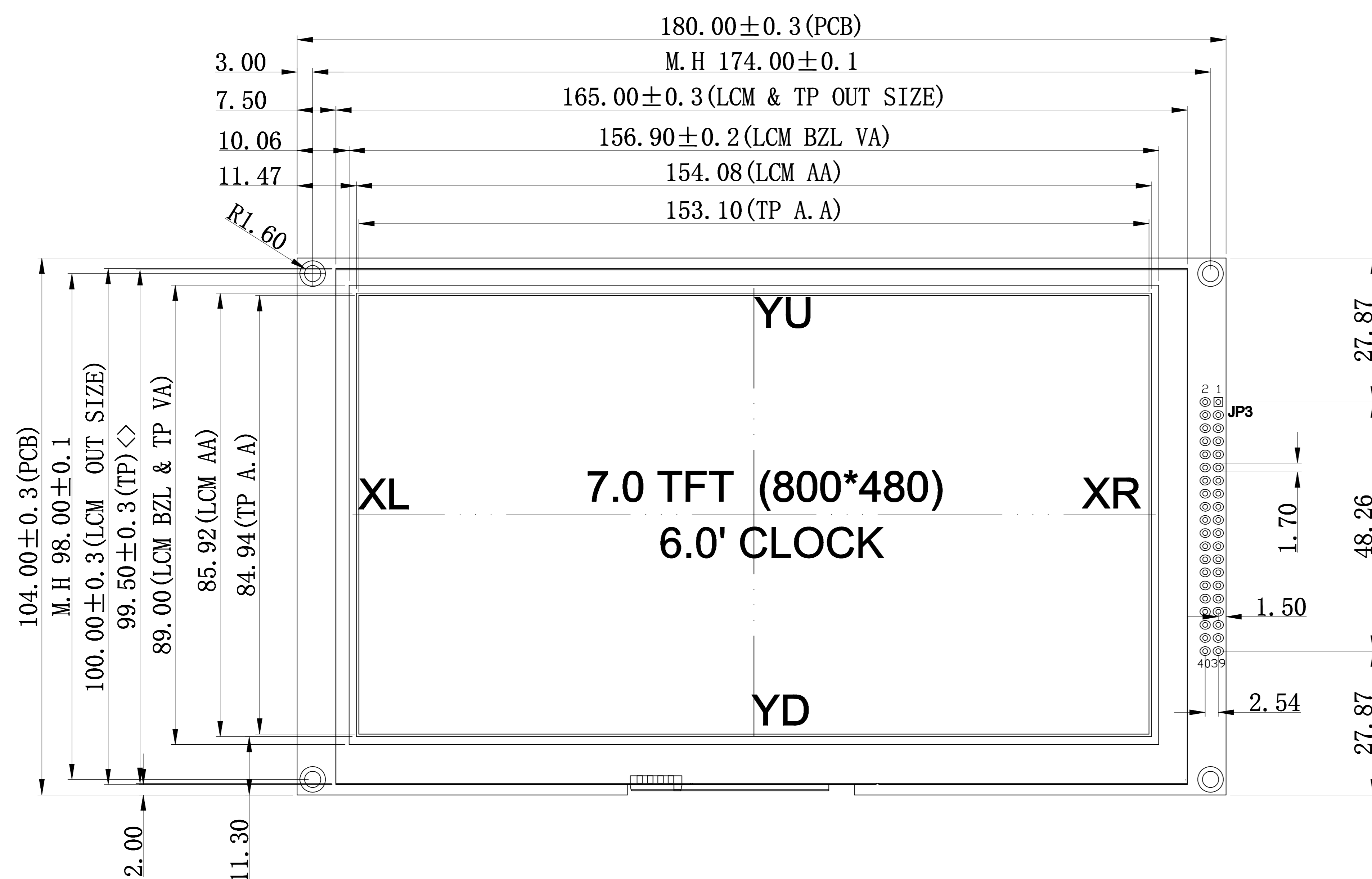

Pad No.	Pad Name
1	VSS
2	VSS
3	VDD
4	VDD
5	/RD /SCS
6	R/W-W/R SDO
7	/CS SDI
8	RS SCLK
9	WAIT
10	INT
11	/RESET(NC)
12	C86(NC)
13	VSS
14	BL-CONTROL
15	DB0
16	DB1
17	DB2
18	DB3
19	DB4
20	DB5
21	DB6
22	DB7
23	DB8
24	DB9
25	DB10
26	DB11
27	DB12
28	DB13
29	DB14
30	DB15
31	VSS
32	CTP-WAKE
33	CTP-INT
34	CTP-SDA
35	CTP-SCL
36	CTP-/RST
37	VDD
38	VDD
39	VSS
40	VSS

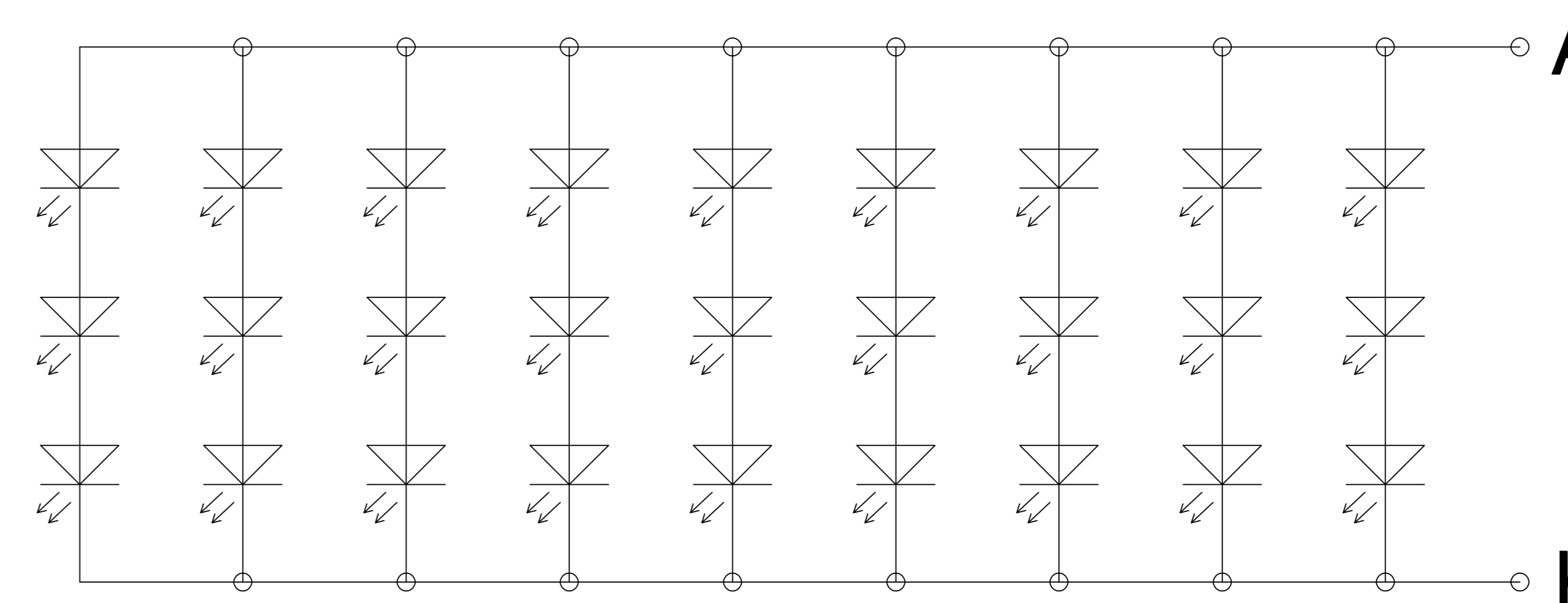

LED CIRCUIT

No.	Item	Specification	Unit
1	LCM Design	7.0TFT+RTP+PCBA	-
2	Number of Pixels	800(W)x3(RGB)x480(H)	pixels
3	Active Area	154.08(H)x85.92(V)	mm
4	Outline Dimension	180.00(W)x104.00(H)x12.0(T)	mm
5	Display Mode	Normally white TN,Transmissive	-
6	Viewing Direction	6 O'clock	-
7	Display Color	16.7M	-
8	Contrast Ratio	500(TYPE)	-
9	Backlight	White LED(3*9)	-
10	Luminance(cd/m2)	600(MIN)	cd/m2
11	Operation Temp.	-20~70 °C	°C
12	Operation Current	850 mA @ 3.3V	mA
13	Interface	4-Wire SPI Serial Port(1-8PIN)	-
14	Download Port	NC	-
15	External Interface	I2C, 3-Wire SPI,MCU Interface	-

UNLESS OTHERWISE NOTED:

DRAWING TYPE: **CD**REV: **A0**

UNITS

DECIMAL

DRAWING No.: **FSD070AT50BS1-T01**

MM	OVER	INCLUDING	
	0 TO 6	±0.1	
	6 TO 30	±0.2	
	30 TO 100	±0.3	

CHECKED BY: DATE:

ANGLES

PLATED THRU HOLES

THIRD ANGLE PROJECTION

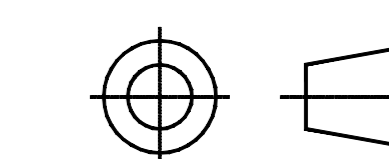

±0.5° NON-PLATED THRU HOLES

SCALE 1 : 1

SHEET: 1 OF 1

4

3

2

1