

| | | | |
|-----|--------------|----|------|
| REV | DESCRIPTION: | BY | DATE |
| | | | |

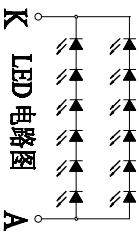
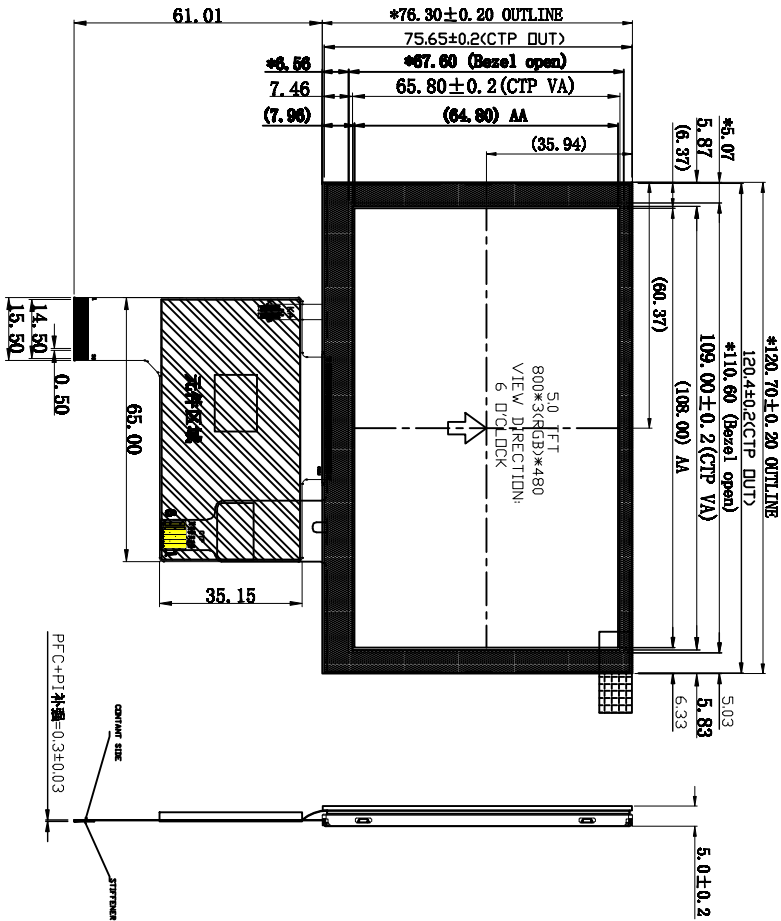

| Pad No. | Pad Name |
|---------|------------|
| 1 | NC |
| 2 | NC |
| 3 | GND |
| 4 | VDD-BL |
| 5 | VDD-BL |
| 6 | GND |
| 7 | USB-DM |
| 8 | USB-DP |
| 9 | GND |
| 10 | TXD |
| 11 | RXD |
| 12 | LT-RST |
| 13 | PWM01 |
| 14 | AIN3 |
| 15 | INT02 |
| 16 | INT17 |
| 17 | LT-PWM0 |
| 18 | LT-PWM1 |
| 19 | LT-RST |
| 20 | GND |
| 21 | VDD-3.3V |
| 22 | F-SPL-CS0 |
| 23 | F-SPL-CS1 |
| 24 | F-SPL-SCLK |
| 25 | F-SPL-SI |
| 26 | F-SPL-SO |
| 27 | GND |
| 28 | GND |
| 29 | VBUS |
| 30 | VBUS |

| No. | Item | Specification | Unit |
|-----|--------------------|---------------------------------|--------|
| 1 | LCM Design | 5.0FT+CTP(G+G)+FPCA | - |
| 2 | Number of Pixels | 800(W)x3(RGB)x480(H) | pixels |
| 3 | Active Area | 108.00(H)x64.80(V) | mm |
| 4 | Outline Dimension | 120.70(W)x76.30(H)x4.2(T) | mm |
| 5 | Display Mode | Normally white TN, Transmissive | - |
| 6 | Viewing Direction | 6 O'clock | - |
| 7 | Display Color | 16.7M | - |
| 8 | Contrast Ratio | 500(TYPE) | - |
| 9 | Backlight | White LED(6*2) | - |
| 10 | Luminance(cd/m2) | 450(MIN) | cd/m2 |
| 11 | Operation Temp. | -20~70 °C | °C |
| 12 | Operation Current | 350 mA @ 3.3V | mA |
| 13 | Interface | TTL UART Serial Port (HMI) | - |
| 14 | Download Port | NC | - |
| 15 | External Interface | MCU & FLASH Burn | - |

| | | | | | |
|-------------------------|--|------------------------|-------------------|------|----|
| UNLESS OTHERWISE NOTED: | | DRAWING TYPE: | HMI | REV: | A0 |
| UNITS | DECIMAL | DRAWING No.: | FNC050AT30FT1-C02 | | |
| MM | 0 TO 6 ±0.1 6 TO 30 ±0.2 30 TO 100 ±0.3 | CHECKED BY: | DATE: | | |
| ANGLES | PLATED THRU HOLES +0.08 NON-PLATED THRU HOLES -0.03 | THIRD ANGLE PROJECTION | | | |
| ±0.5° | | SCALE 1 : 1 | SHEET: 1 OF 1 | | |